

Female thread single wall manifold - 1 coupler and drain - 1/4" Industrial Profile



Inlet NPT female thread

1/2" FNPT

Outlet 1 coupling

ISI 06

Technology

"One push" safety system
(avoids hose whip)

Operating pressure

29 to 174 psi

Flow rate at 100 psi

34 cfm ($\Delta P = 10$ psi)

ID Passage

1/4" body size

Temperature

+5°F to +158°F

Construction

Composite body

Highlight

Anti-static Non scratch

Description

Reference	Inlet NPT female thread	Outlet 1 coupling
ISI 061203WK	1/2" FNPT	ISI 06

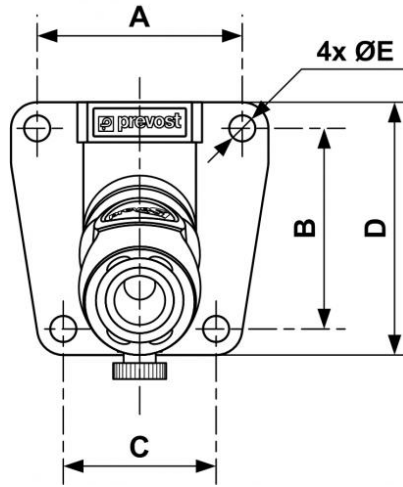

Dimensions

Reference	A inch	B inch	C inch	D inch	E inch
ISI 061203WK	2.008	1.969	1.496	2.736	0.256