

PPS - Aluminum blue bent link pipe



<p><u>Pipe OD (in)</u></p> <p>1/2"</p>	<p><u>Technology</u></p> <p>PPS Grip Concept</p>	<p><u>Operating pressure</u></p> <p>0 to 16 bar</p>	<p><u>Vacuum capability</u></p> <p>-0.98 bar (vacuum 98%)</p>
<p><u>Temperature</u></p> <p>-20°C to +80°C</p>	<p><u>Construction</u></p> <p>Pipe and fittings: alu.</p>	<p><u>Highlight</u></p> <p>Scalable system</p>	<p><u>Meets standards</u></p> <p>PED REACH</p>

Description	
Reference	Pipe OD (in)
PPS LMCB16	1/2"
PPS LMCB20	3/4"

Reference	Pipe OD (in)
PPS LMCB25	1"

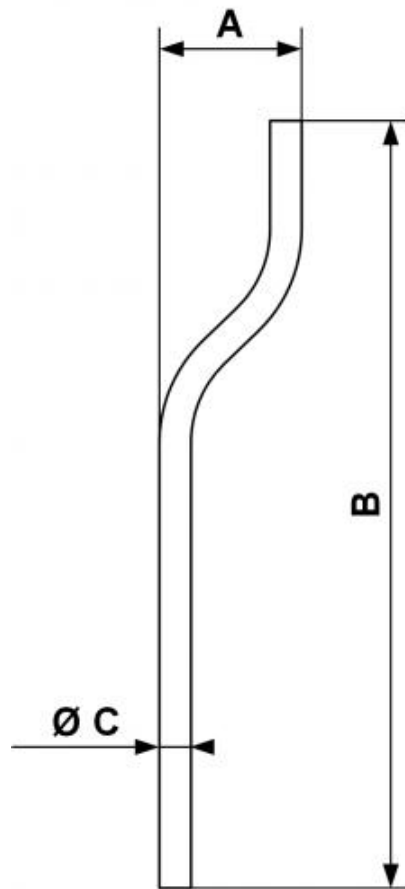

Dimensions

Reference	A inch	B inch	C inch
PPS LMCB16	3.386	18.898	0.63
PPS LMCB20	3.543	19.173	0.787
PPS LMCB25	3.74	19.173	0.984