

## PPS GSQ - SQ Profile grey

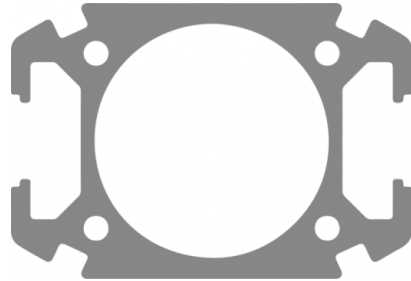

<p><b><u>Pipe ID (in)</u></b> 1"</p>	<p><b><u>Length (ft)</u></b> 3.28</p>	<p><b><u>Technology</u></b> PPS Grip Concept</p>	<p><b><u>Operating pressure</u></b> 0 to 232 psi</p>
<p><b><u>Vacuum capability</u></b> -29 inHg (vacuum 98%)</p>	<p><b><u>Temperature</u></b> -4°F to +176°F</p>	<p><b><u>Construction</u></b> Pipe and fittings: aluminum</p>	<p><b><u>Highlight</u></b> Scalable system</p>
<p><b><u>Meets standards</u></b> ASME B31.3 REACH</p>			

Description		
Reference	Pipe ID (in)	Length (ft)
PPS GSQ2503	1"	3.28
PPS GSQ2506	1"	6.56

