

Parallel male thread - Hose tail - 1 barb - JFT ZS



BSPB male thread

1/8" MBSP

For hose ID (mm)

4

Technology

Straight through path

Operating pressure

0 to 217 psi

Description

Reference	BSPB male thread	For hose ID (mm)
JFT 1804ZS	1/8" MBSP	4
JFT 1806ZS	1/8" MBSP	6
JFT 1406ZS	1/4" MBSP	6
JFT 1408ZS	1/4" MBSP	8
JFT 1409ZS	1/4" MBSP	9
JFT 1410ZS	1/4" MBSP	10
JFT 3808ZS	1/8" MBSP	8
JFT 3810ZS	G 3/8	10
JFT 3813ZS	1/8" MBSP	13
JFT 3816ZS	1/8" MBSP	16
JFT 1208ZS	1/2" MBSP	8

Reference	BSPB male thread	For hose ID (mm)
JFT 1209ZS	1/2" MBSP	9
JFT 1210ZS	G 1/2	10
JFT 1213ZS	1/2" MBSP	13
JFT 1216ZS	1/2" MBSP	16
JFT 3416ZS	3/4" MBSP	16

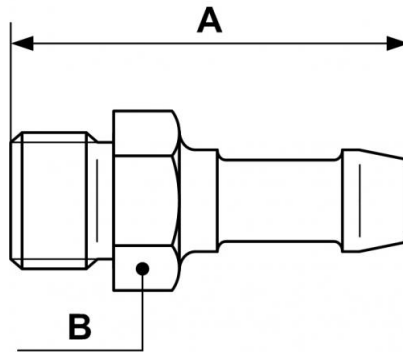

Dimensions

Reference	A inch	B inch
JFT 1804ZS	0.14107611548556	0.045931758530184
JFT 1806ZS	0.14107611548556	0.045931758530184
JFT 1406ZS	0.1509186351706	0.055774278215223
JFT 1408ZS	0.1509186351706	0.055774278215223
JFT 1409ZS	0.1509186351706	0.055774278215223
JFT 1410ZS	0.1509186351706	0.055774278215223
JFT 3808ZS	0.15419947506562	0.062335958005249
JFT 3810ZS	47	19
JFT 3813ZS	0.17060367454068	0.062335958005249
JFT 3816ZS	0.17060367454068	0.075459317585302
JFT 1208ZS	0.1738845144357	0.075459317585302
JFT 1209ZS	0.1738845144357	0.075459317585302
JFT 1210ZS	53	23
JFT 1213ZS	0.1738845144357	0.075459317585302
JFT 1216ZS	0.17716535433071	0.075459317585302
JFT 3416ZS	0.19028871391076	0.095144356955381