

Mini Worm Clamps

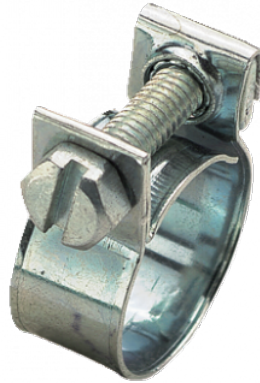

Ø min./max. (in)

0.24 - 0.31

Tightening screw

(lbf.ft)

1.1

Band width (in)

0.354

Construction

Treated zinc-plated steel

Description

Reference	Ø min./max. (in)	Tightening screw (lbf.ft)	Band width (in)
PBM 8	0.24 - 0.31	1.1	0.354
PBM 9	0.28 - 0.35	1.1	0.354
PBM 10	0.31 - 0.39	1.1	0.354
PBM 11	0.35 - 0.43	1.1	0.354
PBM 12	0.35 - 0.47	1.1	0.354
PBM 13	0.39 - 0.51	1.1	0.354
PBM 14	0.43 - 0.55	1.1	0.354

Reference	Ø min./max. (in)	Tightening screw (lbf.ft)	Band width (in)
PBM 15	0.47 - 0.59	1.1	0.354
PBM 16	0.51 - 0.63	1.1	0.354
PBM 17	0.55 - 0.67	1.1	0.354

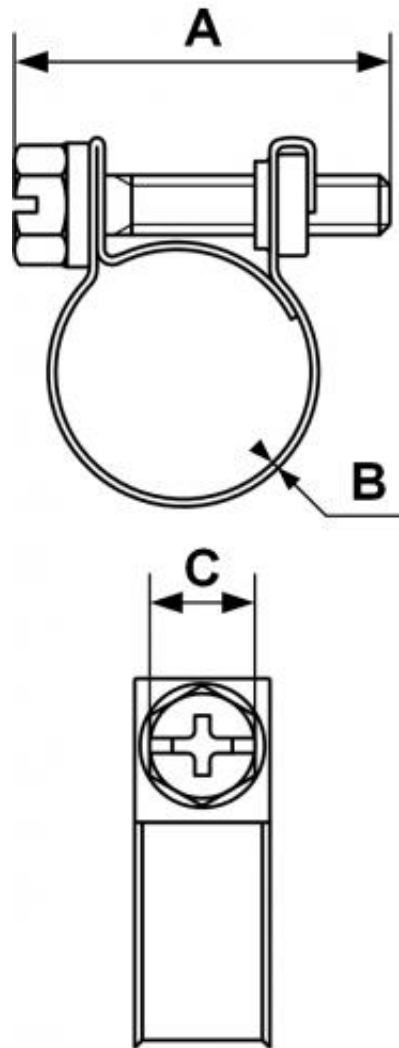

Dimensions

Reference	A inch	B inch
PBM 8	0.709	0.02
PBM 9	0.709	0.02
PBM 10	0.709	0.02
PBM 11	0.827	0.02
PBM 12	0.827	0.02
PBM 13	0.827	0.02

Reference	A inch	B inch
PBM 14	0.827	0.02
PBM 15	0.984	0.02
PBM 16	0.984	0.02
PBM 17	0.984	0.02