

Hose stem coupler - Stainless Steel



For hose ID

1/4" Hose Barb

Technology

Push button

Operating pressure

0 to 174 psi

Flow rate at 100 psi

32 cfm ($\Delta P = 10$ psi)

ID Passage

1/4" body size

Temperature

+5°F to +158°F

Construction

Composite body Stainless steel valve

Applications

Corrosive atmospheres

Highlight

Non scratch

Description

Reference

PROXI 061806

For hose ID

1/4" Hose Barb

Reference	For hose ID
PROXI 061810	3/8" Hose Barb

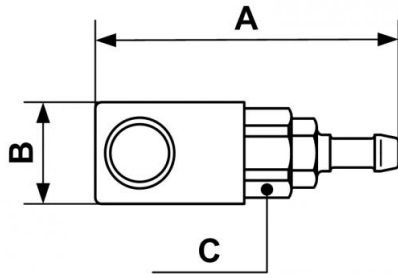

Dimensions

Reference	A inch	B inch	C inch
PROXI 061806	0.25590551181102	0.091863517060367	0.075459317585302
PROXI 061810	0.25590551181102	0.091863517060367	0.075459317585302