

## Female plug - Stainless Steel



**BSPP female thread**

1/4" FBSP

**Technology**

Push button

**Operating pressure**

0 to 174 psi

**Flow rate at 100 psi**

32 cfm ( $\Delta P = 10$  psi)

**ID Passage**

1/4" body size

**Temperature**

+5°F to +158°F

**Construction**

Composite body Stainless steel valve

**Applications**

Corrosive atmospheres

**Highlight**

Non scratch

### Description

Reference

BSPP female thread

**PROXI 066101**

1/4" FBSP

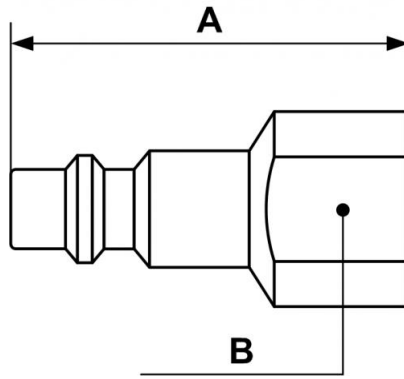

### Dimensions

Reference	A inch	B inch
<b>PROXI 066101</b>	0.13123359580052	0.055774278215223