

Male plug - Stainless Steel



BSPT male thread

1/4" MBSP

Technology

Push button

Operating pressure

0 to 174 psi

Flow rate at 100 psi

32 cfm ($\Delta P = 10$ psi)

ID Passage

1/4" body size

Temperature

+5°F to +158°F

Construction

Composite body Stainless steel valve

Applications

Corrosive atmospheres

Highlight

Non scratch

Description

Reference	BSPT male thread
PROXI 066151	1/4" MBSP
PROXI 066152	3/8" MBSP

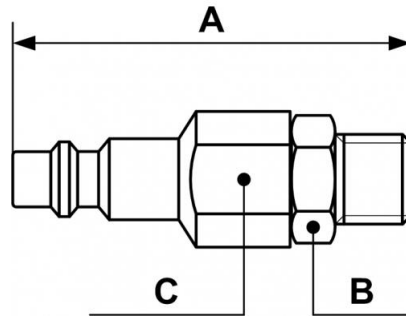

Dimensions

Reference	A inch	B inch	C inch
PROXI 066151	0.21325459317585	0.055774278215223	0.055774278215223
PROXI 066152	0.21325459317585	0.055774278215223	0.065616797900262