

Unvalved hose stem coupler



For hose ID

3/4" Hose Barb

Operating pressure

0 to 145 psi

Flow rate

6.34 GPM ($\Delta P = 4.35$ psi valved coupling), 8.85 GPM ($\Delta P = 4.35$ psi straight through-coupling)

ID Passage

9 mm

Temperature

+5°F to +140°F

Construction

Brass body

Description

Reference

ELS 090819

For hose ID

3/4" Hose Barb

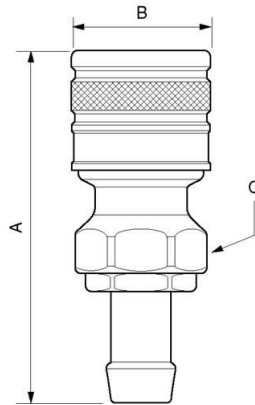

Dimensions

Reference	A inch	B inch	C inch
ELS 090819	0.29199475065617	0.11482939632546	0.098425196850394