

Parallel female thread adaptor



BSPF female thread

G 1/4

ID Passage

6 mm

Construction

Stainless steel

Description

Reference	BSPF female thread	NPT female thread
CRP 066101	G 1/4	1/4" FNPT
CRP 066201		3/8" FNPT
CRP 066202		

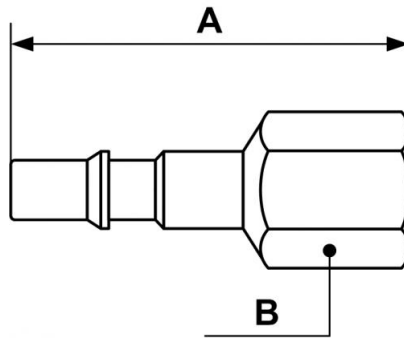

Dimensions

Reference	A inch	B inch
CRP 066101	50	17
CRP 066201	0.16404199475066	0.055774278215223
CRP 066202	0.17716535433071	0.078740157480315