

## Straight union for tubes - RPU ET



For tube OD (mm)

4

Operating pressure

0 to 10 bar

Temperature

0°C to + 60°C

Construction

Polymer and nickel-plated  
brass

### Description

| Reference  | For tube OD (mm) |
|------------|------------------|
| RPU ET0404 | 4                |
| RPU ET0606 | 6                |
| RPU ET0808 | 8                |
| RPU ET1010 | 10               |
| RPU ET1212 | 12               |
| RPU ET1414 | 14               |
| RPU ET1616 | 16               |

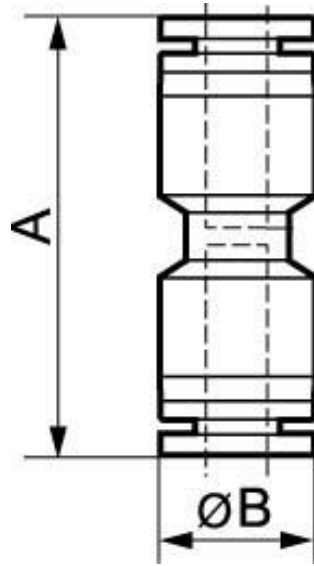

**Dimensions**

| Reference         | A inch           | B inch            |
|-------------------|------------------|-------------------|
| <b>RPU ET0404</b> | 30               | 10                |
| <b>RPU ET0606</b> | 36.7             | 12.8              |
| <b>RPU ET0808</b> | 39               | 13.8              |
| <b>RPU ET1010</b> | 0.13845144356955 | 0.05511811023622  |
| <b>RPU ET1212</b> | 0.14534120734908 | 0.06496062992126  |
| <b>RPU ET1414</b> | 0.16240157480315 | 0.074475065616798 |
| <b>RPU ET1616</b> | 0.16272965879265 | 0.078083989501312 |