

Straight union for unequal tubes - Metric tube - RPU IT



For tube OD (mm)

4

Operating pressure

0 to 145 psi

Temperature

+32°F to +140°F

Construction

Polymer and nickel-plated brass

Description

Reference	For tube OD (mm)
RPU IT0604	4
RPU IT0806	6
RPU IT1008	8
RPU IT1210	10
RPU IT1612	12

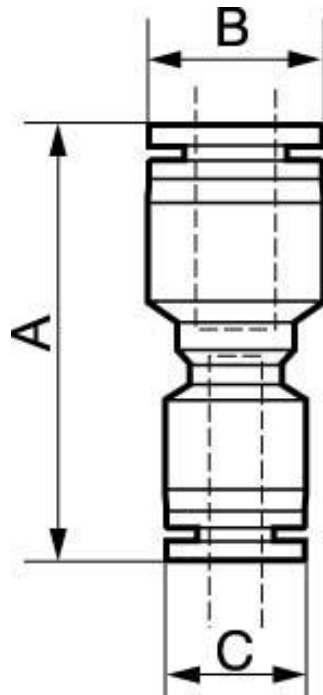

Dimensions

Reference	A inch	B inch	C inch
RPU IT0604	0.10859580052493	0.041994750656168	0.032808398950131
RPU IT0806	0.125656167979	0.045275590551181	0.041994750656168
RPU IT1008	0.13484251968504	0.05511811023622	0.045275590551181
RPU IT1210	0.1486220472441	0.06496062992126	0.05511811023622
RPU IT1612	0.16272965879265	0.078083989501312	0.064304461942257