

Female elbow - Metric tube to female BSPP - RPC FG



BSPP female thread

1/8" FBSP

For tube OD (mm)

4

Operating pressure

0 to 145 psi

Temperature

+32°F to +140°F

Construction

Polymer and nickel-plated
brass

Description

Reference	BSPP female thread	For tube OD (mm)
RPC FG0400	1/8" FBSP	4
RPC FG0401	1/4" FBSP	4
RPC FG0600	1/8" FBSP	6
RPC FG0601	1/4" FBSP	6
RPC FG0602	3/8" FBSP	6
RPC FG0603	1/2" FBSP	6
RPC FG0800	1/8" FBSP	8
RPC FG0801	1/4" FBSP	8

Reference	BSPF female thread	For tube OD (mm)
RPC FG0802	3/8" FBSP	8
RPC FG0803	1/2" FBSP	8
RPC FG1000	1/8" FBSP	10
RPC FG1001	1/4" FBSP	10
RPC FG1002	3/8" FBSP	10
RPC FG1003	1/2" FBSP	10
RPC FG1201	1/4" FBSP	12
RPC FG1202	3/8" FBSP	12
RPC FG1203	1/2" FBSP	12
RPC FG1402	3/8" FBSP	14
RPC FG1403	1/2" FBSP	14
RPC FG1602	3/8" FBSP	16
RPC FG1603	1/2" FBSP	16

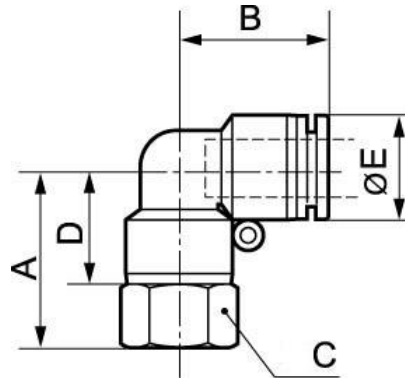

Dimensions

Reference	A inch	B inch	C inch	D inch	E inch
RPC FG0400	0.073818897637795	0.05741469816273	0.039370078740158	0.050853018372703	0.032808398950131
RPC FG0401	0.075459317585302	0.05741469816273	0.055774278215223	0.050853018372703	0.032808398950131
RPC FG0600	0.082020997375328	0.067257217847769	0.039370078740158	0.059055118110236	0.041994750656168
RPC FG0601	0.083661417322835	0.067257217847769	0.055774278215223	0.059055118110236	0.041994750656168
RPC FG0602	0.085301837270341	0.067257217847769	0.062335958005249	0.059055118110236	0.041994750656168
RPC FG0603	0.091863517060367	0.067257217847769	0.078740157480315	0.059055118110236	0.041994750656168
RPC FG0800	0.08759842519685	0.073818897637795	0.045931758530184	0.064632545931759	0.045275590551181
RPC FG0801	0.089238845144357	0.073818897637795	0.055774278215223	0.064632545931759	0.045275590551181
RPC FG0802	0.090879265091864	0.073818897637795	0.062335958005249	0.064632545931759	0.045275590551181
RPC FG0803	0.09744094488189	0.073818897637795	0.078740157480315	0.064632545931759	0.045275590551181
RPC FG1000	0.099081364829396	0.086286089238845	0.062335958005249	0.076115485564305	0.05511811023622
RPC FG1001	0.1007217847769	0.086286089238845	0.062335958005249	0.076115485564305	0.05511811023622
RPC FG1002	0.10236220472441	0.086286089238845	0.062335958005249	0.076115485564305	0.05511811023622
RPC FG1003	0.10892388451444	0.086286089238845	0.078740157480315	0.076115485564305	0.05511811023622
RPC FG1201	0.10334645669291	0.091207349081365	0.062335958005249	0.078740157480315	0.06496062992126

Reference	A inch	B inch	C inch	D inch	E inch
RPC FG1202	0.10498687664042	0.091207349081365	0.068897637795276	0.078740157480315	0.06496062992126
RPC FG1203	0.11154855643045	0.091207349081365	0.078740157480315	0.078740157480315	0.06496062992126
RPC FG1402	0.10990813648294	0.097769028871391	0.072178477690289	0.083661417322835	0.074475065616798
RPC FG1403	0.11646981627297	0.097769028871391	0.078740157480315	0.083661417322835	0.074475065616798
RPC FG1602	0.11482939632546	0.1010498687664	0.078740157480315	0.088582677165354	0.078083989501312
RPC FG1603	0.12139107611549	0.1010498687664	0.078740157480315	0.088582677165354	0.078083989501312