

## Straight female connector - Metric tube to M5 - RPD FG



**Metric female  
threading**

M5

**Construction**

Polymer and nickel-plated  
brass

**For tube OD (mm)**

4

**Operating pressure**

0 to 145 psi

**Temperature**

+32°F to +140°F

### Description

| Reference         | Metric female threading | For tube OD (mm) |
|-------------------|-------------------------|------------------|
| <b>RPD FG04M5</b> | M5                      | 4                |
| <b>RPD FG06M5</b> | M5                      | 6                |

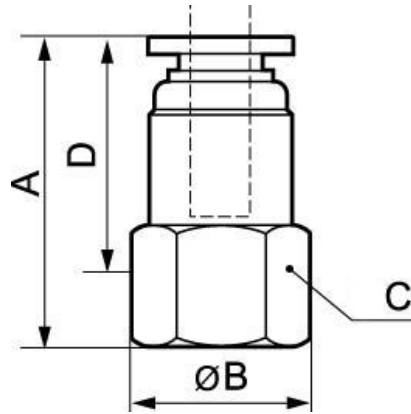

### Dimensions

| Reference         | A inch            | B inch            | C inch            | D inch            |
|-------------------|-------------------|-------------------|-------------------|-------------------|
| <b>RPD FG04M5</b> | 0.072178477690289 | 0.045931758530184 | 0.039370078740158 | 0.055774278215223 |
| <b>RPD FG06M5</b> | 0.077099737532808 | 0.054133858267717 | 0.045931758530184 | 0.060695538057743 |