

Hose stem

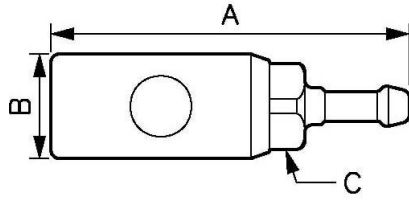

<p><u>For hose ID</u> 1/4" Hose Barb</p>	<p><u>Technology</u> Push button</p>	<p><u>Operating pressure</u> 0 to 174 psi</p>	<p><u>Flow rate at 100 psi</u> 34 cfm ($\Delta P = 10$ psi)</p>
<p><u>ID Passage</u> 3/8" body size</p>	<p><u>Temperature</u> +5°F to +158°F</p>	<p><u>Highlight</u> Non scratch</p>	

Description	
Reference	For hose ID
ERC 071806	1/4" Hose Barb
ERC 071810	3/8" Hose Barb
ERC 071813	1/2" Hose Barb



Dimensions

Reference	A inch	B inch	C inch
ERC 071806	0.31332020997375	0.091863517060367	0.075459317585302
ERC 071810	0.31332020997375	0.091863517060367	0.075459317585302
ERC 071813	0.32972440944882	0.091863517060367	0.075459317585302