

Straight female connector - Fractional inch tube to 10-32 UNF - RPD FG



UNF thread

10-32 UNF

For tube OD (in)

1/8

Operating pressure

0 to 145 psi

Temperature

+32°F to +140°F

Construction

Polymer and nickel-plated
brass

Description

Reference	UNF thread	For tube OD (in)
RPD FG1826	10-32 UNF	1/8

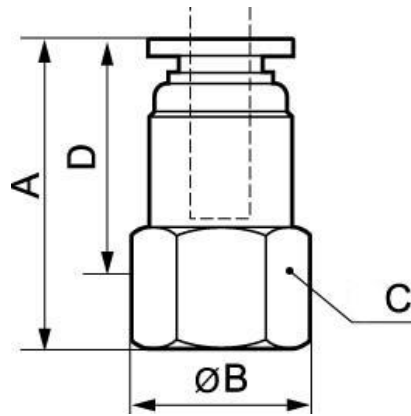

Dimensions

Reference	A inch	B inch	C inch	D inch	E inch
RPD FG1826	0.073818897637795	0.022965879265092	147.5	0.016404199475066	0.032808398950131