

## Female coupler



**NPT female thread**

1/4" FNPT

**Technology**

"One push" safety system  
(avoids hose whip)

**Operating pressure**

29 to 174 psi

**Flow rate at 100 psi**

34 cfm ( $\Delta P = 10$  psi)

**ID Passage**

1/4" body size

**Temperature**

+5°F to +158°F

**Construction**

Composite body

**Highlight**

Anti-static Non scratch

### Description

Reference	NPT female thread
<b>ISI 061201</b>	1/4" FNPT
<b>ISI 061202</b>	3/8" FNPT
<b>ISI 061203</b>	1/2" FNPT

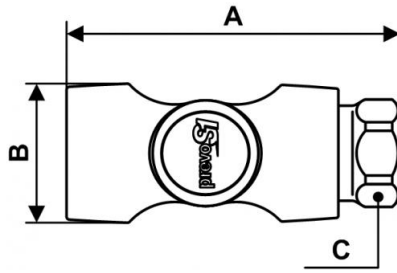

### Dimensions

Reference	A inch	B inch	C inch
<b>ISI 061201</b>	0.22309711286089	0.098425196850394	0.065616797900262
<b>ISI 061202</b>	0.23622047244094	0.098425196850394	0.065616797900262
<b>ISI 061203</b>	0.25918635170604	0.098425196850394	0.075459317585302