

Bulkhead coupler

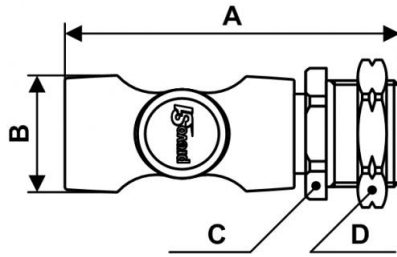

| | | | |
|---|---|--|---|
| <p><u>NPT female thread</u> 1/4" FNPT</p> | <p><u>Drill Ø (in)</u> 1.06</p> | <p><u>Panel depth (in)</u> 0.43</p> | <p><u>Technology</u> "One push" safety system (avoids hose whip)</p> |
| <p><u>Operating pressure</u> 29 to 174 psi</p> | <p><u>Flow rate at 100 psi</u> 34 cfm ($\Delta P = 10$ psi)</p> | <p><u>ID Passage</u> 1/4" body size</p> | <p><u>Temperature</u> +5°F to +158°F</p> |
| <p><u>Construction</u> Composite body</p> | <p><u>Highlight</u> Anti-static Non scratch</p> | | |

| Description | | | |
|-------------------|-------------------|--------------|------------------|
| Reference | NPT female thread | Drill Ø (in) | Panel depth (in) |
| ISI 062201 | 1/4" FNPT | 1.06 | 0.43 |



Dimensions

| Reference | A inch | B inch | C inch | D inch |
|-------------------|-----------------|-------------------|-------------------|------------------|
| ISI 062201 | 0.2755905511811 | 0.098425196850394 | 0.095144356955381 | 0.10498687664042 |