

## Female coupler



**NPT female thread**

1/4" FNPT

**Technology**

"One push" safety system  
(avoids hose whip)

**Operating pressure**

29 to 174 psi

**Flow rate at 100 psi**

81 cfm ( $\Delta P = 10$  psi)

**ID Passage**

3/8" body size

**Temperature**

+5°F to +158°F

**Construction**

Composite body

**Highlight**

Anti-static Non scratch

### Description

Reference	NPT female thread
<b>USI 081201</b>	1/4" FNPT
<b>USI 081202</b>	3/8" FNPT
<b>USI 081203</b>	1/2" FNPT

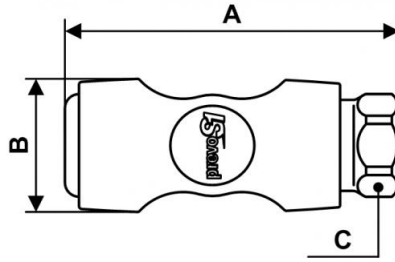

### Dimensions

Reference	A inch	B inch	C inch
<b>USI 081201</b>	0.27034120734908	0.10826771653543	0.075459317585302
<b>USI 081202</b>	0.27034120734908	0.10826771653543	0.075459317585302
<b>USI 081203</b>	0.2998687664042	0.10826771653543	0.075459317585302