

## Female coupler - Stainless Steel



**BSPF female thread**

1/4" FBSP

**Technology**

"One push" safety system  
(avoids hose whip)

**Operating pressure**

29 to 174 psi

**Flow rate at 100 psi**

73 cfm ( $\Delta P = 10$  psi)

**ID Passage**

3/8" body size

**Temperature**

+5°F to +158°F

**Construction**

Composite body Stainless  
steel valve

**Applications**

Corrosive atmospheres

**Highlight**

Anti-static Non scratch

### Description

Reference

BSPF female thread

**ESI 071101HE**

1/4" FBSP

**ESI 071102HE**

3/8" FBSP

Reference	BSPP female thread
ESI 071103HE	1/2" FBSP

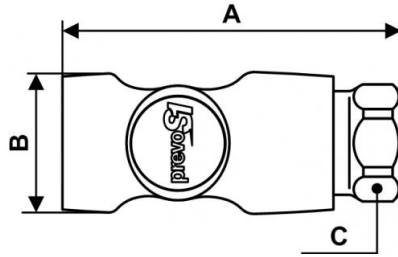

### Dimensions

Reference	A inch	B inch	C inch
<b>ESI 071101HE</b>	0.24048556430446	0.10564304461942	0.075459317585302
<b>ESI 071102HE</b>	0.24048556430446	0.10564304461942	0.085301837270341
<b>ESI 071103HE</b>	0.26345144356955	0.10564304461942	0.085301837270341